



INSTRUCTIONS FOR WALL TILES

(See overleaf for Floor Tiles)

Works on: Sanded and Unsanded Grout, as well as Sanded Epoxy & Silicone Grouts.

IMPORTANT:

For Grout Shield to work effectively, your grout line must be below the level of the tile, the more of a dip in the existing grout line, the easier it will be to apply the Grout Shield Colour Seal.

GENERAL:

- Read all instructions fully before starting.
- Make sure the tiled surface is generally clean and dry.
- Have the 2 orange chamois cloths and a bucket of clean warm water close by.
- Cover the area directly under where you are working, with a cloth/sheet.

TIPS:

- Use a VERY thin line of Colour Seal (max 2mm wide). You will need less than you think.
- It's easier to add a little more Colour Seal after if needed.
- Make sure you Colour Seal all the grout lines in one direction first i.e. horizontal.
- Then starting in the same corner, all the lines in the other direction.
- Try not to leave Colour Seal to dry on the tiled surface, it is easier to remove when wet.
- To prevent it drying on the tile, do one or two lines (of approx 1 metre) at a time, completing stages 4-7 opposite, before doing the next two lines.

1 X 230ML COLOUR SEAL WILL RESTORE 15 SQM OF 15CM TILES IN LESS THAN 3 HOURS

CLEAN

The Pre-Cleaner will not remove all stains, just excess dirt and grease. It opens the pores of the grout to receive the Colour Seal.



Spray

Spray Pre-Cleaner onto grout lines and leave for 2 minutes.

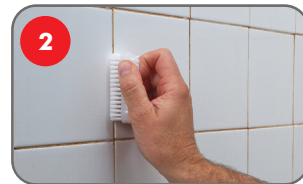

Brush

Use a scrubbing brush to thoroughly scrub the grout lines.

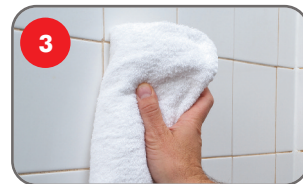

Dry

Use a towel/cloth to remove any excess fluid.

COLOUR SEAL

See Tips opposite:

Pick your starting point and do all lines in one direction first. Complete 4-7 below on one or two lines at a time, to prevent the Colour Seal drying.



Apply

Place nozzle on grout line and squeeze bottle. As the Colour Seal comes out, move the bottle along the grout line.



Brush in

Brush the Colour Seal into the grout line. On vertical lines, brush upwards.



Smooth out

Going in one direction, smooth along the line with the side of your finger, a few tiles at a time.

Remove any excess from tiles

(use one or a combination of the methods below).



a) With orange chamois cloth. If you have a good deep grout line, this is the best method. Using the folded edge of a damp cloth, wipe lightly over the tiles in one smooth motion. Rinse cloth regularly, and refold. If your tiles are uneven, wipe across from the higher tile.



b) With red scraper tool. If you have a shallow grout line, use the flat edge of the scraper. This tool is more accurate. Run the flexible edge over the line. Wipe the scraper clean as needed.

FINAL CLEAN

After 20 minutes clean tiles with a standard glass or multi-surface cleaner. Avoid acidic cleaners at this early stage. Polish tiled area with a dry towel or micro-fibre cloth. The treated area will be fully sealed, dry and ready to use after approximately 3 hours.

When finished remove nozzle from bottle, replace cap and rinse nozzle in warm water for future use.

Each bottle will cover grout on approx:

10 square metres of 10cm x 10cm tiles

15 square metres of 15cm x 15cm tiles

25 square metres of 30cm x 30cm tiles

30 square metres of 40cm x 40cm tiles

Safe

Grout Shield Pre-Cleaner and Grout Shield Colour Seal are non-hazardous and biodegradable. As with all cleaning/DIY products, please Keep Away From Children.

NON-HAZARDOUS BIODEGRADABLE ✓